

StarMark® Architectural Wall System Specifications

STAR MARK® ARCHITECTURAL WALL SYSTEM

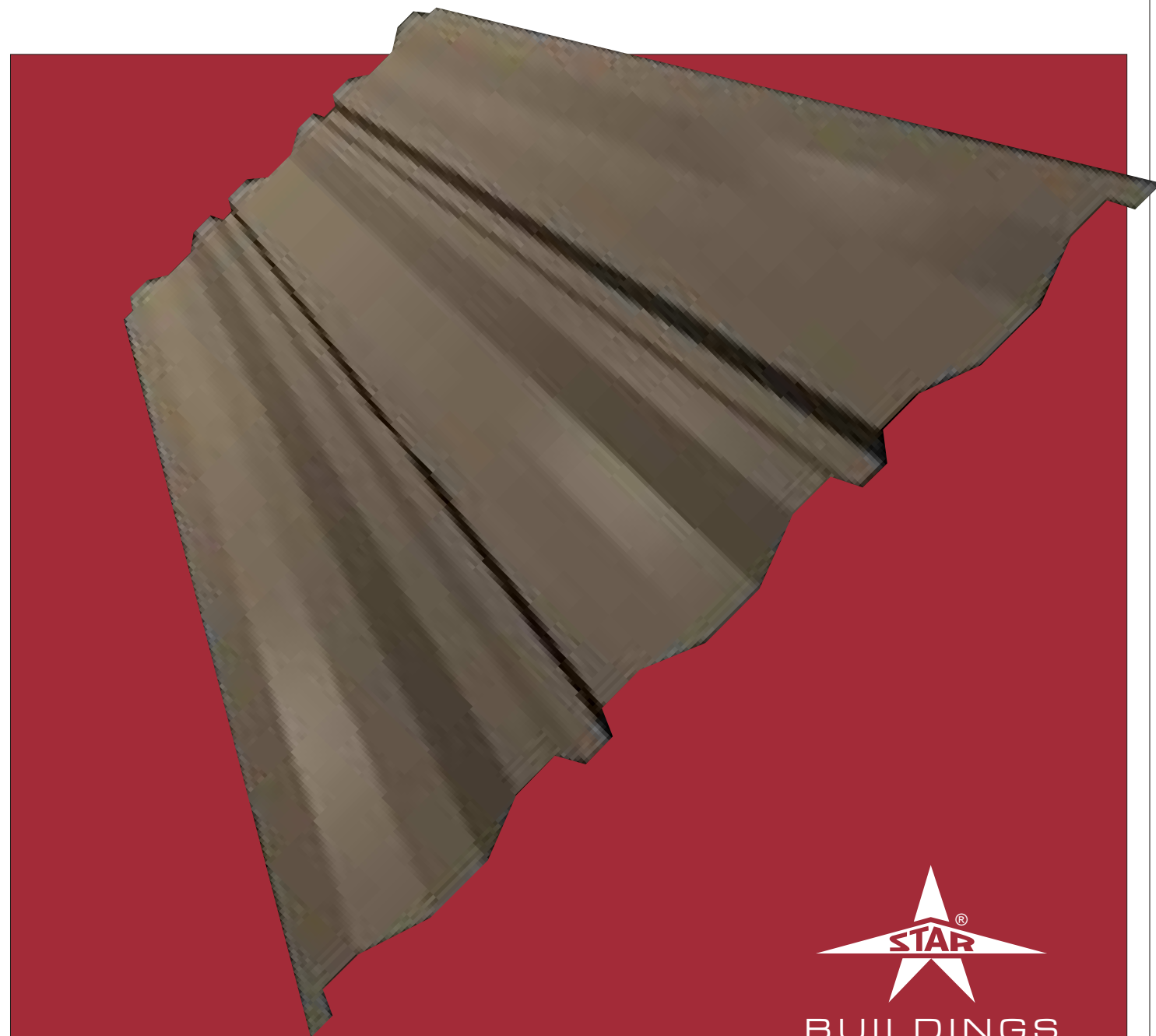

StarMark® ARCHITECTURAL WALL SYSTEM PANEL PROFILE AND PROPERTIES

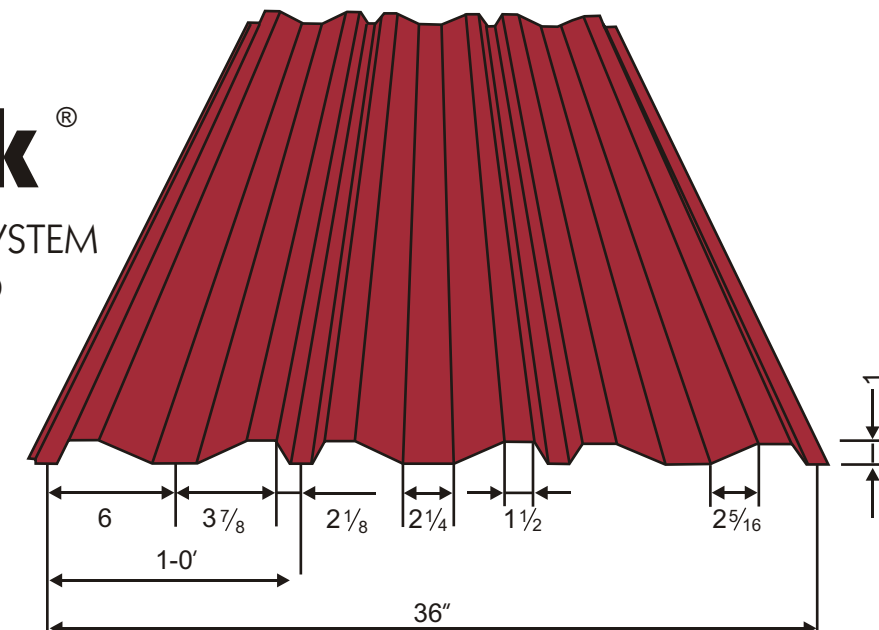

ENGINEERING PROPERTIES OF STARMARK ARCHITECTURAL WALL PANEL

GAUGE	STEEL THK. (IN.)	COATED THK. (IN.)	FY (KSI)	WEIGHT (#/FT ²)	OUTSIDE IN COMPRESSION		INSIDE IN COMPRESSION		F _b (KSI)
					I _x (IN. ⁴ /FT.)	S _x (IN. ³ /FT.)	I _x (IN. ⁴ /FT.)	S _x (IN. ³ /FT.)	
26	.018	.0198	50	.933	.03748	.05073	.03552	.05763	30
24	.022	.0239	50	1.128	.04551	.06160	.04313	.06998	30

1. Section properties have been calculated in accordance with the 1986 AISI Cold-Formed Steel Specifications with 1989 Addendum.
2. Steel thickness was used in determining section properties. Coated thickness includes galvanized or zinc-aluminum coating.

ALLOWABLE LOAD (PSF) FOR NOMINAL GIRTS SPACING

SPAN CONDITION	LOAD CONDITION	GIRT SPACING (IN FEET)			SPAN CONDITION	LOAD CONDITION	GIRT SPACING (IN FEET)				
		5.0	6.0	7.0			5.0	6.0	7.0		
26 GAUGE	SIMPLE	PRESSURE	54.00	37.50	27.55	24 GAUGE	SIMPLE	PRESSURE	65.58	45.54	33.46
			52.42	30.34	19.10				63.65	36.83	23.20
	SUCTION	61.35	42.60	31.30	SUCTION		74.50	51.73	38.01		
		49.68	28.75	18.10			60.32	34.91	21.98		
	2-SPAN	PRESSURE	61.35	42.60	31.30		2-SPAN	PRESSURE	74.50	51.73	38.01
			123.09	71.23	44.86				149.46	86.49	54.47
SUCTION	54.00	37.50	27.55	SUCTION	65.58	45.54	33.46				
	123.09	71.23	44.86		149.46	86.49	54.47				
3-SPAN	PRESSURE	76.69	53.25	39.13	3-SPAN	PRESSURE	93.12	64.67	47.51		
		96.33	55.75	35.10			116.97	67.69	42.63		
		67.50	46.88	34.44			81.97	56.92	41.82		
SUCTION	96.33	55.75	35.10	SUCTION	116.97	67.69	42.63				

1. Top values are based on stress. 1/3 for wind load is included.
2. Bottom values are based on deflection of L/120 for 10 year wind (L/90 for 50 year wind).
3. Standard fastener pullover allowable is 222 lbs. including 1.3 increase for wind (#12 fastener without washer).



Star Building Systems
 8600 S. Interstate 35
 P.O. Box 94910
 Oklahoma City, OK 73143
 (800) 654-3921
 FAX (405) 636-2037



Star Building Systems are erected by independent building contractors, not agents of Star All Star claims as to the ultimate performance of its products are contingent upon proper erection techniques as employed by the erecting contractor. These techniques must be in accordance with Star's suggested erection procedures. Star is not liable for damages incurred through improper erection procedures. Descriptions and specifications contained herein were in effect at the time this publication was approved for printing. Star reserves the right to discontinue products at any time or change specifications and/or designs without notice and without incurring obligation.

I. GENERAL

A. The wall system will consist of metal panels joined together with fasteners through overlapping sidelaps and secured to the structure with fasteners. Integral components such as corner trim, base trim and eave trim will be furnished as required.

II. PANEL DESCRIPTION

A. All panels will be precision roll formed to provide 36" wide net coverage. Finished panels will have four major corrugations 1" high at 12" on center, with a 2-1/4" x 1" deep depression between each major corrugation.

III. PANEL DESIGN

A. Panel design shall be in accordance with AISI "Specification for the Design of Light-Gauge, Cold Formed Steel Structural Members," and in accordance with sound engineering methods and practices.

IV. PANEL MATERIALS AND FINISH

A. The wall will be covered with:

1. StarMark panels of roll formed 26 or 24 gauge, 50,000 PSI minimum yield steel (ASTM A653 Grade 50) with G-90 zinc coating (ASTM Galvanized Specification A924) or Aluminum-Zinc alloy coating (ASTM Specification A792).
2. Factory colored StarMark panels of 26 or 24 gauge, 50,000 PSI minimum yield steel (ASTM A653 Grade 50) with G90 zinc coating (ASTM Galvanized Specification A924) or Aluminum-Zinc alloy coating (ASTM Specification 792). Siliconized or linear polyester coating can be applied, or an inorganically pigmented 70% polyvinylidene fluoride coating can be applied (70% Kynar).

V. PANEL APPLICATION

A. StarMark wall panels will be one piece construction from base to building eave with a maximum length of 32'. All end laps will be minimum 4" and shall occur at a supporting member.

VI. FASTENERS

A. All connection of wall panels to structural framing shall be made with:

1. #12 - 14 x 7/8" self-drilling screws, long life coated, painted to match wall color, no sealing washer.
2. #12 - 14 x 1-1/4" self-drilling screws, long life coated, painted to match wall color, no sealing washer (optional).
3. 1/4 - 14 x 3/4" self-drilling screws, long life coated, painted to match wall color, no sealing washer (stitch fastener).

B. Location of the fasteners shall be as shown on the manufacturer's drawings.

VII. ACCESSORIES

A. Accessories, i.e., doors, windows, louvers shall be as standard with Star Building Systems unless otherwise noted, and furnished as specified.

B. Standard accessory locations shall be as shown on erection drawings as furnished by Star Building Systems.

VIII. TESTING

A. The wall system will be tested for diaphragm action to resist wind load and witnessed by an independent laboratory.

IX. WARRANTIES

A. All wall panels shall be warranted for a period of one year for defects in material or workmanship.

B. Panels finished with siliconized or linear polyester coatings shall be warranted for a period of 5 or 10 years against blistering, peeling, and chalking according to manufacturer's standard warranty. Panels finished with 70% Kynar coating shall be warranted for 20 years.

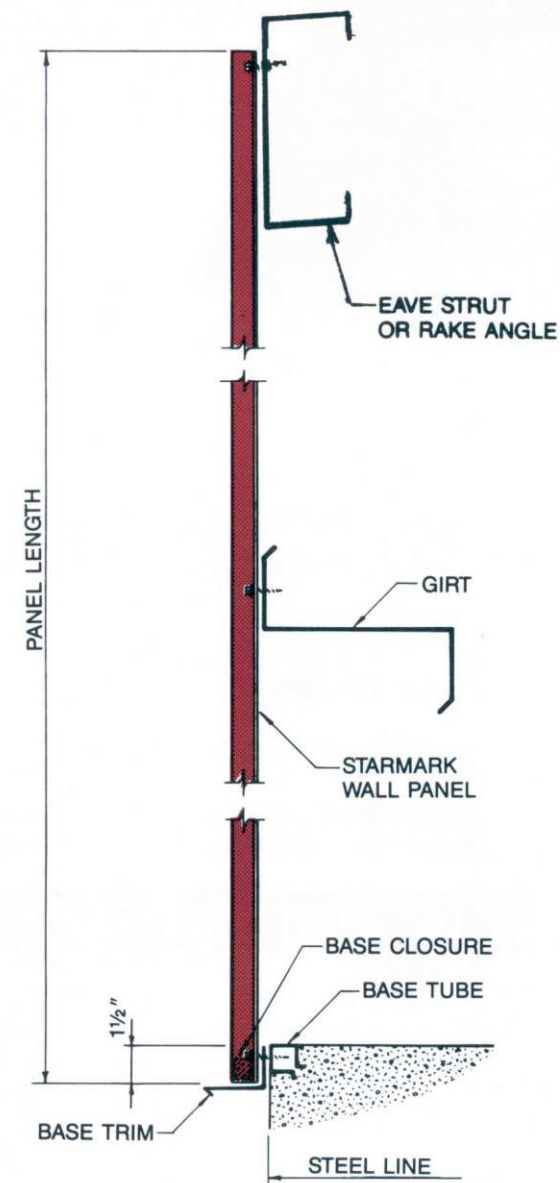

TYPICAL WALL SECTION

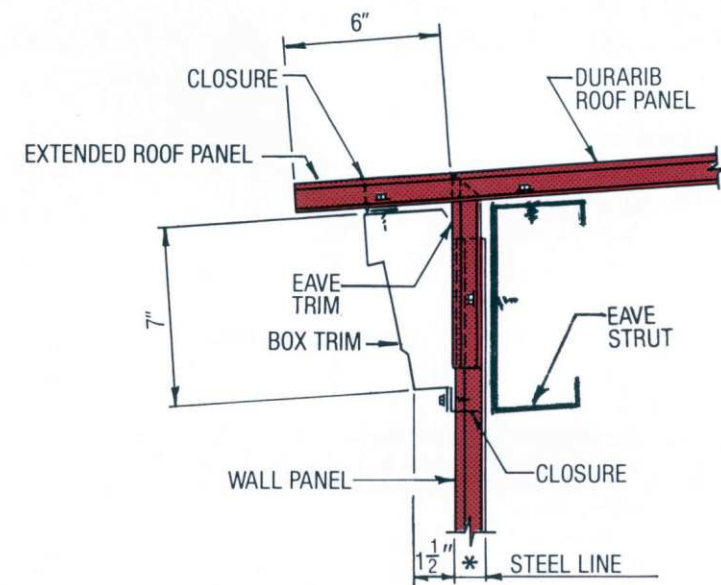

LOW EAVE - BOX TRIM

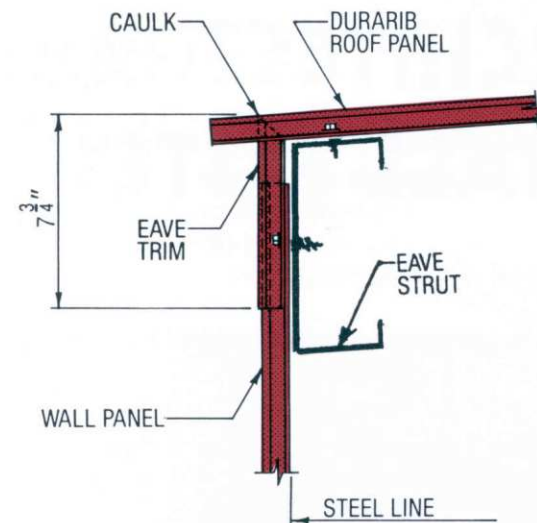

LOW EAVE - PLAIN TRIM

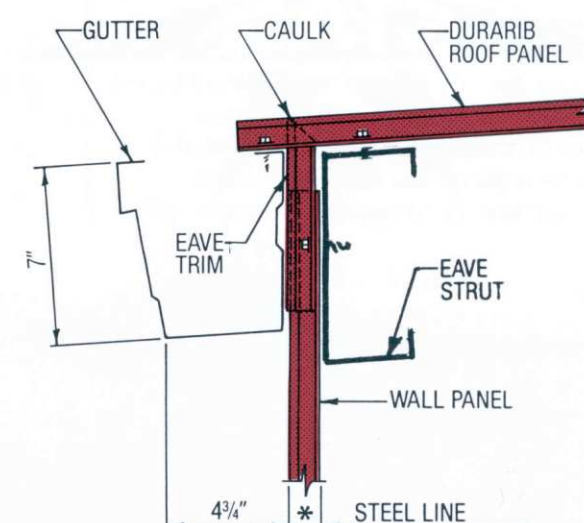

EXTERIOR EAVE GUTTER

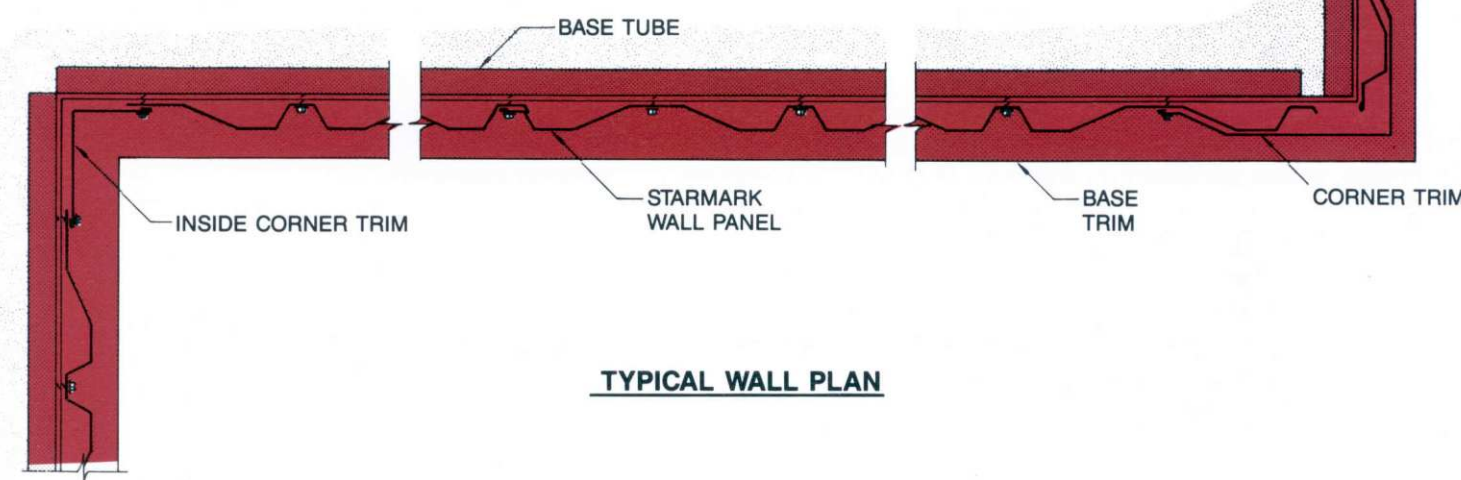

TYPICAL WALL PLAN

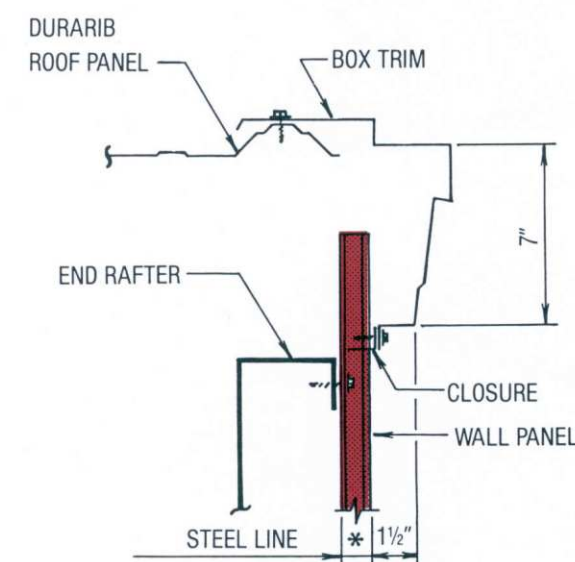

GABLE - BOX TRIM

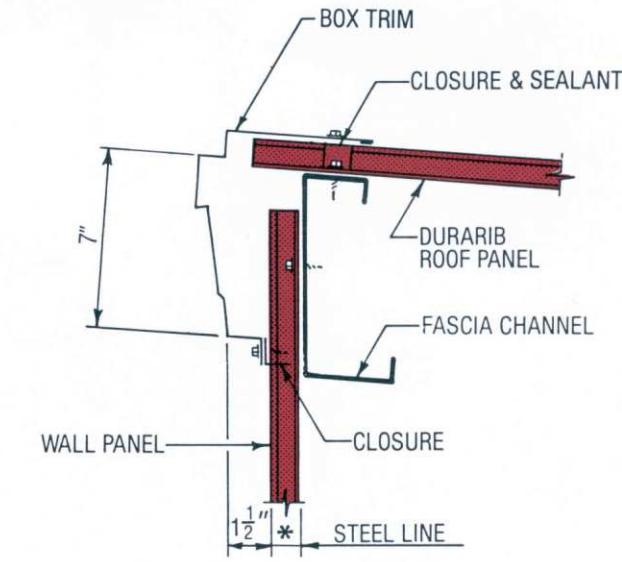

HIGH EAVE - BOX TRIM

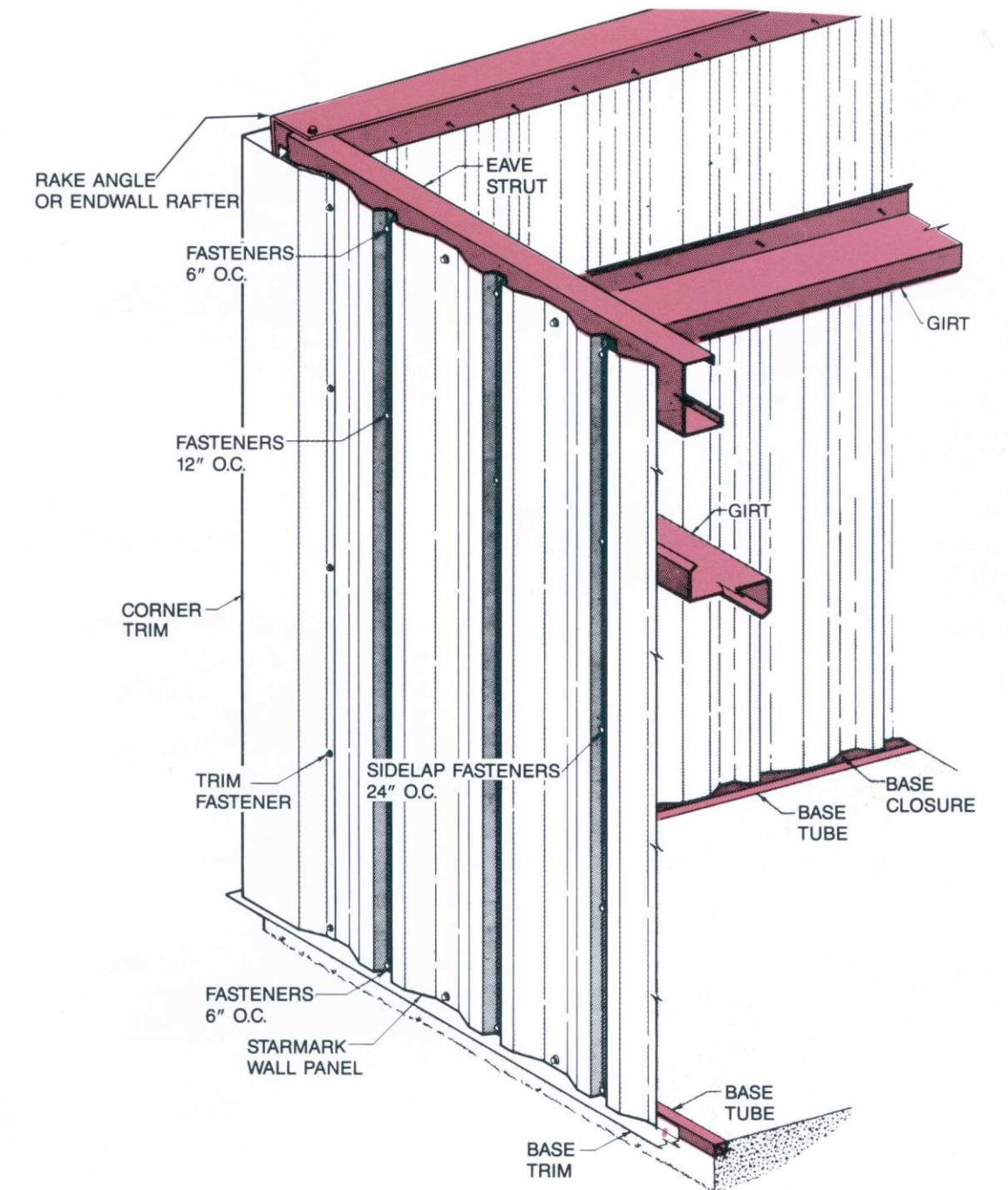

Backed up by finish guarantees of 5 to 20 years, as well as Star Buildings standard one-year material guarantee, **StarMark** panels are designed to keep your Star metal building system virtually maintenance free. Major ribs on 1'-0" centers not only provide panel strength and integrity, they enhance the panels aesthetically pleasing sculptured look as well.

Panel strength is additionally provided by the panel's construction from sturdy 26-gauge steel (24-gauge steel available upon special request). And **StarMark** panels are finished in either a siliconized polyester or 70% Kynar® in a spectrum of colors for added strength and beauty.